

LMS ZigBee Green Power Panel Switch



Specification

- Wireless smart lighting control by L&E Software
“**Lighting Management System, LMS**”
- ZigBee 3.0 Protocol, Low power consumption
- Maximum 30m operating range between each nodes
- 6 keys for Scenes activation with LED indicator
- Workable with both single color and CCT tunable
luminaires
- Magnetic base installation, can be out in any place with
magnetic

Model	SCT-SW-6K-ZBGP-AL-ID-IA
Input Voltage	Battery 3.0 Vdc
Standby Power	< 3 μ A
Battery Type	CR2032
IP Rating	IP20
Body Color	White
Ambient Temperature	-20 ~ 55°C
Dimension	85.6mmx85.6mmx12.5mm
Weight	64g
Battery Lifetime	2 years



LIGHTING MANAGEMENT SYSTEM

Last updated 12-7-2024

LMS ZigBee Green Power Panel Switch

Dimensions

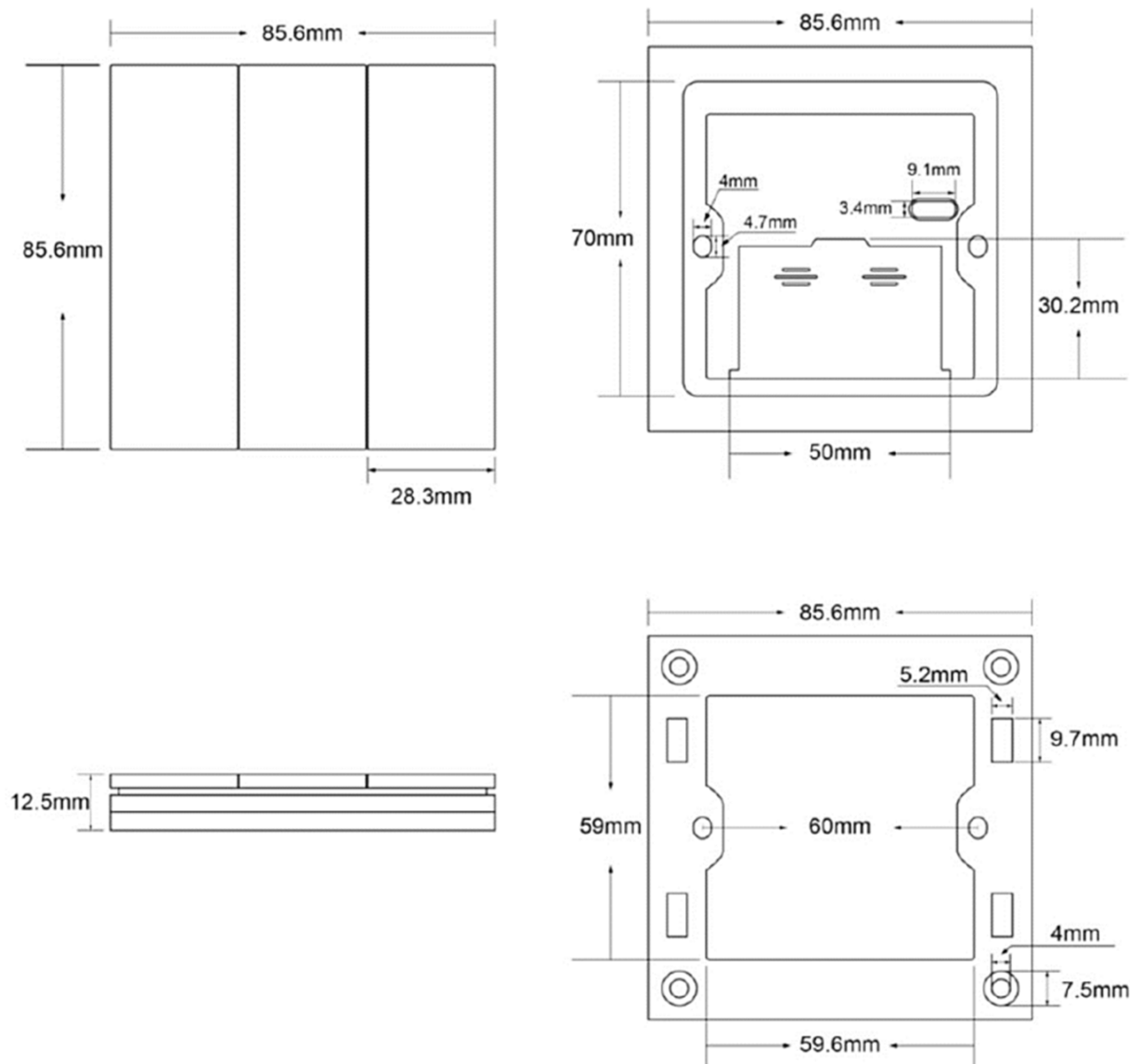

LMS ZigBee Green Power Panel Switch

Installation

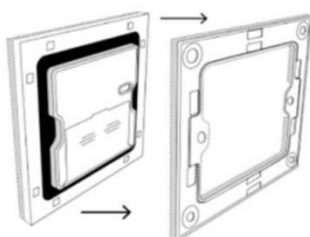

1. Take down the magnetic frame

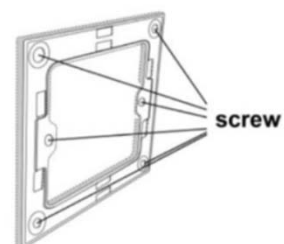

2. Fix the frame by screws or stick to a metal surface.

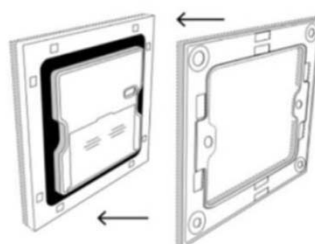

3. Put up the switch in frame

Battery Installation

Prepare battery CR2032x2, Open back cover of battery and operate follow the below picture

